



BANYAN TREE
RESIDENCES
— RIVERSIDE BANGKOK —





BANYAN TREE
RESIDENCES
— RIVERSIDE BANGKOK —



DETAILS
MAKE MAGIC

NIRVANA DAII

Home is where the groundwork for all of life begins.
Meticulous attention to detail is given to creating homes that represent
a place of happiness and achievement that one can build on.

From the selection of materials and location, to the design and finish,
Nirvana Daii ensures that every process is achieved with a mindset of
uncompromising quality.

AT THE HEART OF THE CHAO PHRAYA

A potent symbol of prosperity, abundance and serenity.
Rising from one of the most magnificent bends of the Chao Phraya,
Banyan Tree Residences Riverside Bangkok is destined to honour
the majestic river and its rich history and culture.

“THE SANTUARY FOR YOUR SOUL”

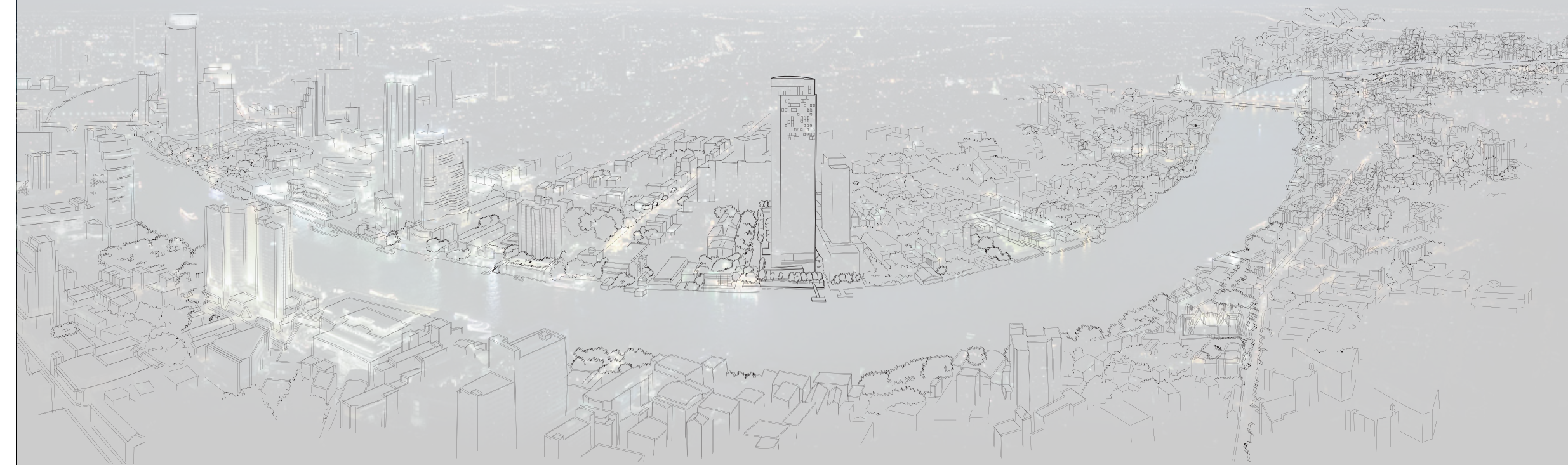



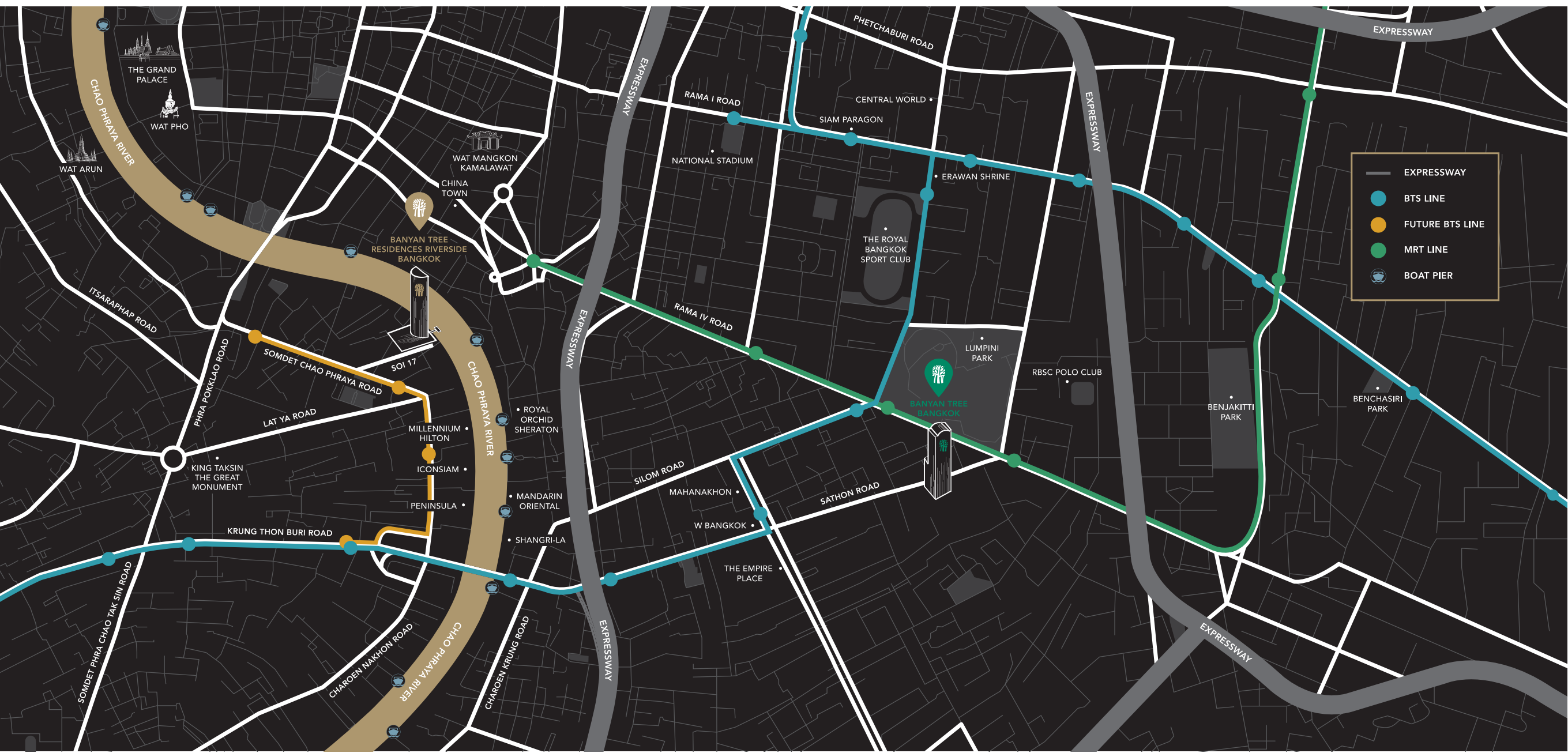

A RARE RIVERSIDE LOCATION

Situated within intimate reach of the river lifestyle, a rarity in the city, Banyan Tree Residences Riverside Bangkok is set in the heart of Chao Phraya River's historical Khlong San district, where past and present gracefully intertwine.

BETWEEN THE OLD CITY

The Chao Phraya River has long shaped a cherished way of life for past generations.

A peaceful atmosphere of old-fashioned charm, historical buildings and cultural treasures can be found and explored along the river.

Banyan Tree Residences Riverside Bangkok brings a nurturing connection to its surrounding communities.





AND THE NEW CITY

In the embrace of the old city and Bangkok's central business district, Banyan Tree Residences Riverside Bangkok enjoys the convenience of cosmopolitan commuting experiences to and from downtown Bangkok with easy expressway access and BTS/MRT transit stations nearby.





CONCIERGE SERVICES

A dedicated Banyan Tree concierge will provide a high level of service for residents.

- Services include but are not limited to:
- Arranging outings for golf tee times, personal trainers, car washing services
 - Information / bookings for events, restaurants, transport, and spa services
 - In-building facilities reservations
 - Postal services and parcel handling

ABOUT BANYAN TREE

Banyan Tree Group operates internationally to provide the ultimate tourism, accommodation and lifestyle experience. Banyan Tree's dedication, innovation and skills create an unrivaled living environment.

A rich heritage and reputation for outstanding quality and service make Banyan Tree one of the world's leading hospitality brands.

An established market leader in multi award winning resorts, spas and private residences.



Casa Lucardo, Tuscany, Italy

Banyan Tree Ringha, China



Chalet Lune, Four Valleys, Switzerland



Pittormie Castle, St. Andrews, Scotland

BANYAN TREE PRIVATE COLLECTION*

Asia's first global destination club that allows members to have complimentary stays at Banyan Tree Private Collection properties and its affiliates.

*A select number of Banyan Tree Private Collection annual memberships will become available to customers upon transfer of select units.

NETWORK

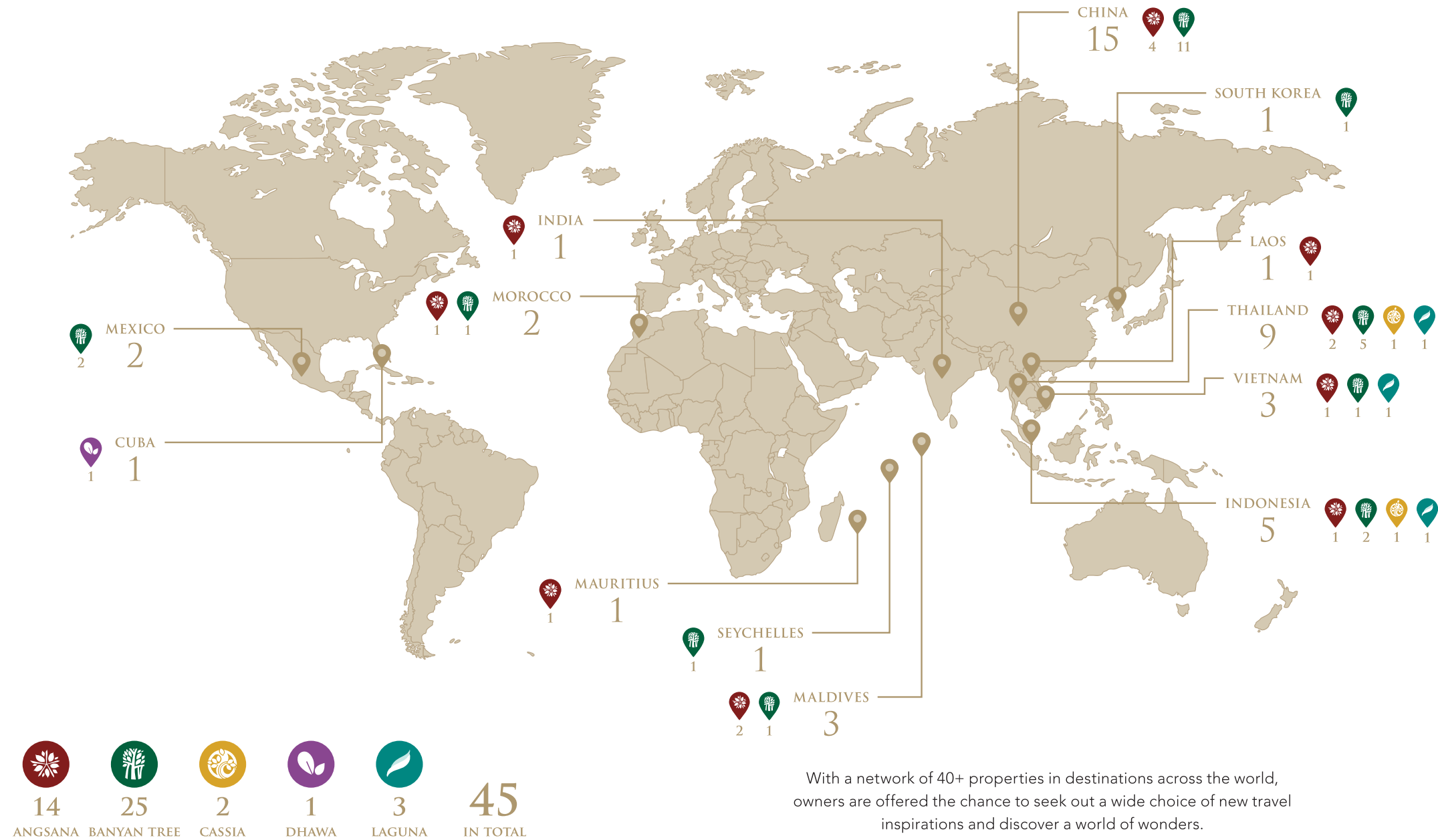

SANCTUARY CLUB

Exclusive complimentary membership for owners.

Discounts and privileges from Banyan Tree Group worldwide at resorts, spas and retail galleries.

Exclusive invitations through the Xperiential guest program for new resort opening.



LET YOUR SOUL SHINE

Escape from the chaos of the city to a home where the luxury of inner peace and privacy is right at your doorstep.

At Banyan Tree Residences Riverside Bangkok, a multitude of thoughtful world class facilities await.

From private lifts to a luxurious fitness center, adult and kids swimming pools to a river facing jacuzzi, Banyan Tree Residences Riverside Bangkok offers holistically rejuvenating and relaxing experiences for the mind, body, and soul.



GROUND FLOOR

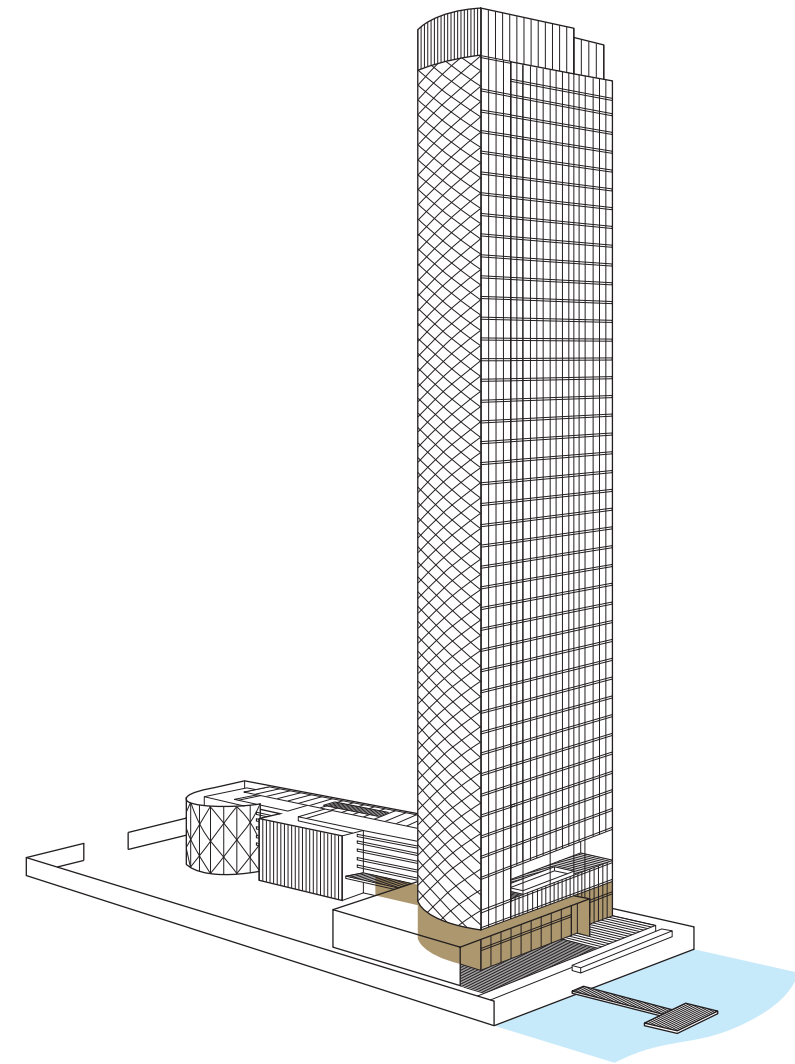

Outdoor Lounge



Main Entrance

GROUND FLOOR

- Residential Lobby
- Riverfront Lounge
- Outdoor Lounge
- Resident Shuttle Boat
- Sunken Seating Area
- Multipurpose Room



Private Resident Shuttle Boat Pier



Private Dining Room



Library Room

SECOND FLOOR

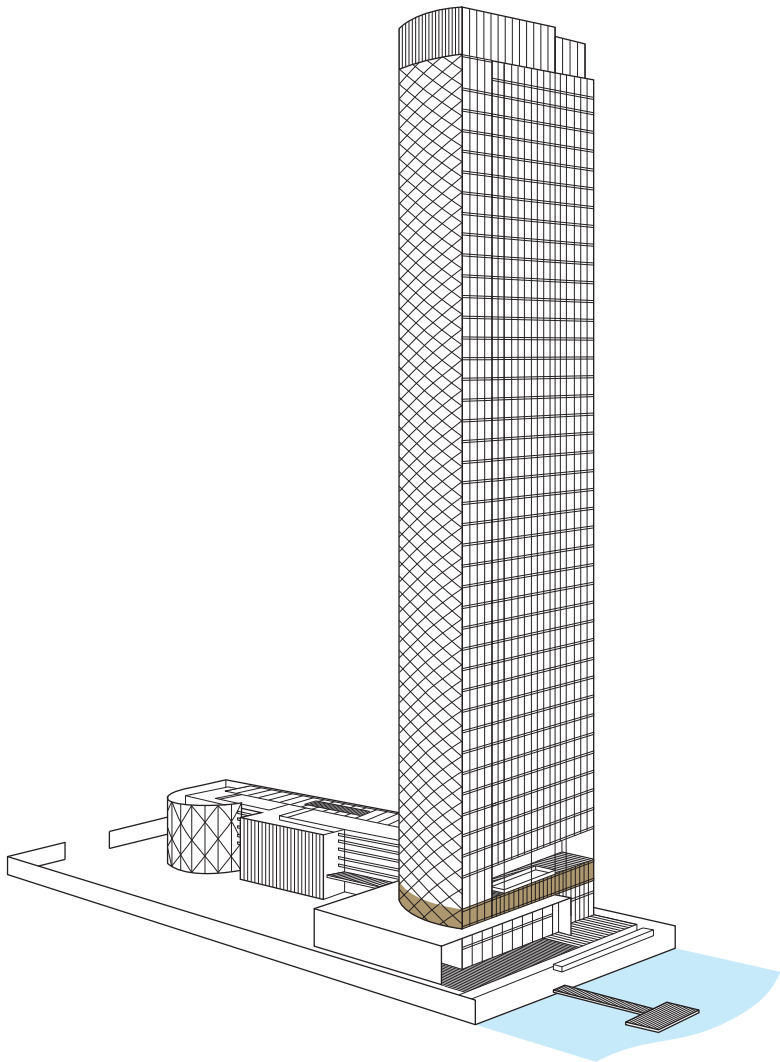

- SECOND FLOOR
- Private Dining Room
 - Prefunction Room
 - River View Owners Lounge
 - Library Room
 - Meeting Room
 - Board Room

THIRD FLOOR

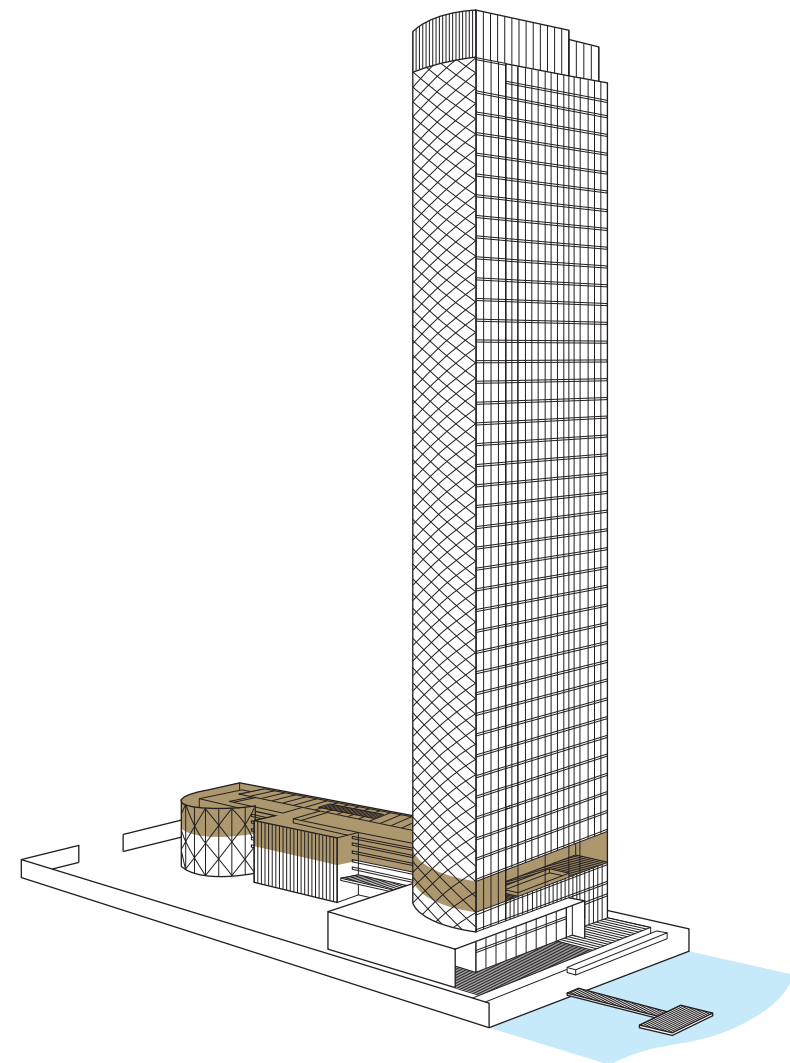

THIRD FLOOR

- Swimming Pool
- Kids Pool
- Cabanas
- Saunas
- Steam Rooms
- Kids Room
- Active Play Area
- Outdoor Lounge & BBQ Area
- River Facing Jacuzzi
- Fitness Center
- Banyan Tree Spa Room



Outdoor Lounge & BBQ Area



Fitness Center



Swimming Pool



“THE SANCTUARY FOR YOUR SOUL”

PRIVATE
LIFT LOBBIES



BANYAN TREE
RESIDENCES
— RIVERSIDE BANGKOK —

UNOBSTRUCTED
VIEW

133 UNITS
LOW - DENSITY
MAXIMUM 4 UNITS/FLOOR

6,000 SQ.M
COVERED FACILITIES

195%
CAR PARKING



INTERIOR DESIGN

A modern interpretation of the Thai way of life along the river, the aesthetic heart of the interior design reflects the minimalist concept of keeping things simple using clean, crisp lines. Expansive windows and high ceilings offer wide open, unobstructed views of sunrises and historical landmarks.











FACTSHEET

PROJECT NAME : Banyan Tree Residences Riverside Bangkok

LOCATION : Chao Phraya Riverside, Charoennakhon Road

PROJECT TYPE : Ultimate Luxury Freehold Condominium
1 Building 45 Stories
133 Riverfront Units
(Maximum 4 Units Per Floor)

DEVELOPER : Nirvana Daii PLC.

TOTAL PROJECT AREA : 5-1-10 Rai

UNIT TYPE AND AREA :	
- 1 Bedroom	70.00 - 87.09 Sq.m
- 2 Bedroom	160.45 - 181.23 Sq.m
- 3 Bedroom	248.29 Sq.m
- 4 Bedroom (Duplex)	426.82 - 429.24 Sq.m
- Penthouse (Duplex)	844.56 Sq.m

PARKING : 260 Vehicles

ARCHITECT / INTERIOR /
LANDSCAPE DESIGNER :
SCDA Singapore

LOCAL ARCHITECT :
CAPA Co. Ltd

PROJECT DESIGNER :
Soo K. Chan

CONTRACTOR :
Bouygues - Thai

AMENITIES

GROUND FLOOR

- Residential Lobby
- Riverfront Lounge
- Outdoor Lounge
- Resident Shuttle Boat
- Sunken Seating Area
- Multipurpose Room

SECOND FLOOR

- Private Dining Room
- Prefunction Room
- River View Owners Lounge
- Library Room
- Meeting Room
- Board Room

THIRD FLOOR

- Swimming Pool
- Kids Pool
- Cabanas
- Saunas
- Steam Rooms
- Kids Room
- Active Play Area
- Outdoor Lounge & BBQ Area
- River Facing Jacuzzi
- Fitness Center
- Banyan Tree Spa Room

SPECIAL FEATURES & SERVICES

- Banyan Tree Spa
- Banyan Tree Concierge Service
- Private Lifts
- Personal/Sports Equipment Storage

BANYAN TREE PRIVILEGES

- Banyan Tree Sanctuary Club
- Banyan Tree Private Collection*

*Subject to certain terms and conditions

GROUND FLOOR PLAN



GROUND FLOOR
AMENITIES



- Residential Lobby
- Riverfront Lounge
- Outdoor Lounge
- Resident Shuttle Boat
- Sunken Seating Area
- Multipurpose Room

SECOND FLOOR AMENITIES



- Private Dining Room
- Prefunction Room
- River View Owners Lounge
- Library Room
- Meeting Room
- Board Room

THIRD FLOOR AMENITIES



- Swimming Pool
- Kids Pool
- Cabanas
- Saunas
- Steam Rooms
- Kids Room
- Active Play Area
- Outdoor Lounge & BBQ Area
- River Facing Jacuzzi
- Fitness Center
- Banyan Tree Spa Room

FLOOR PLAN

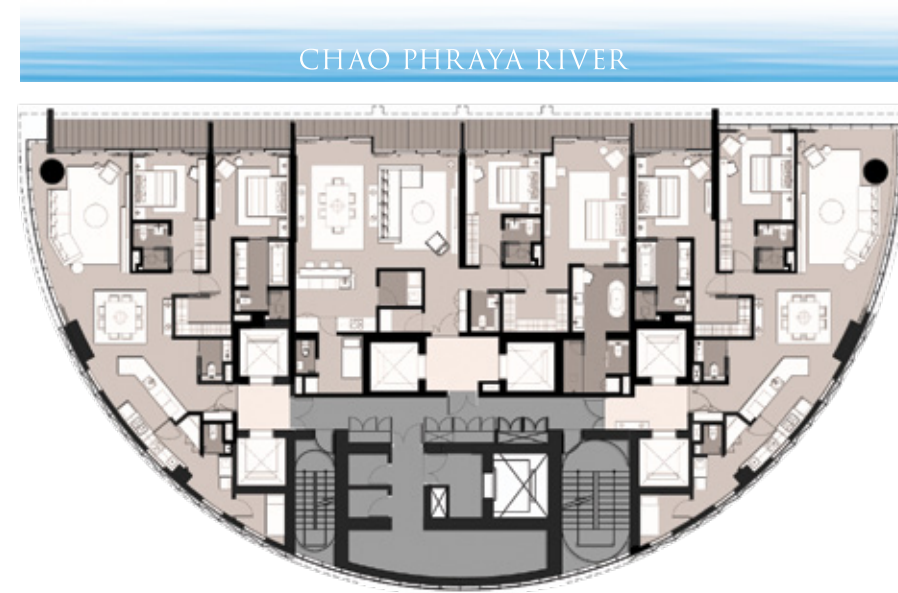

FLOORS 4 - 9

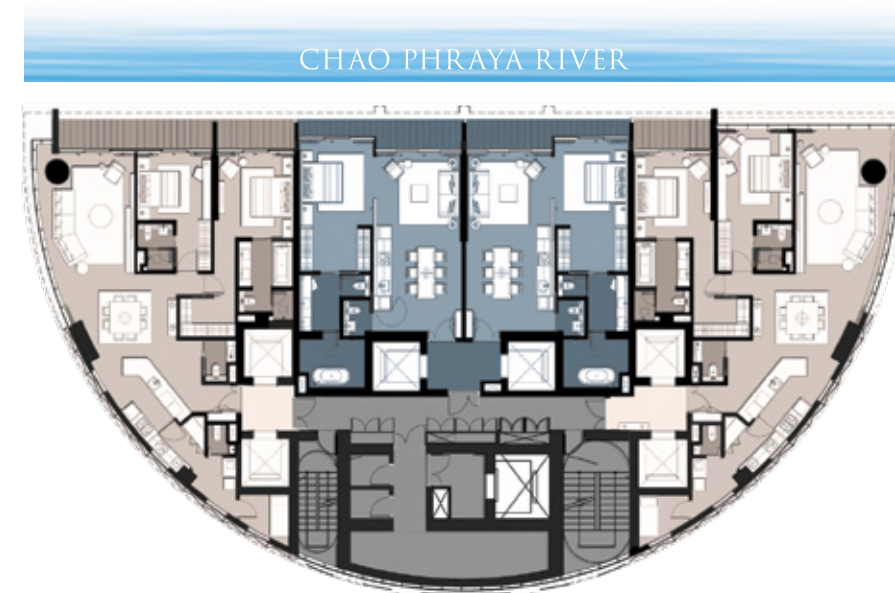

FLOORS 10 - 12

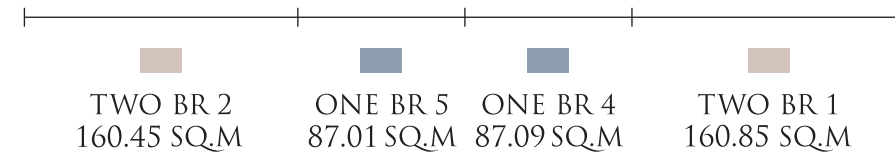

FLOOR PLAN

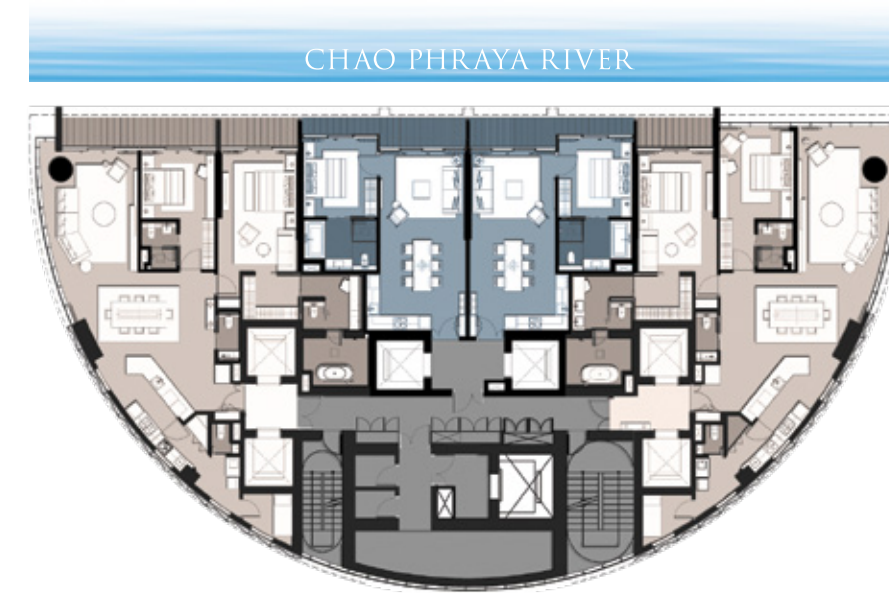

FLOORS 12A - 25

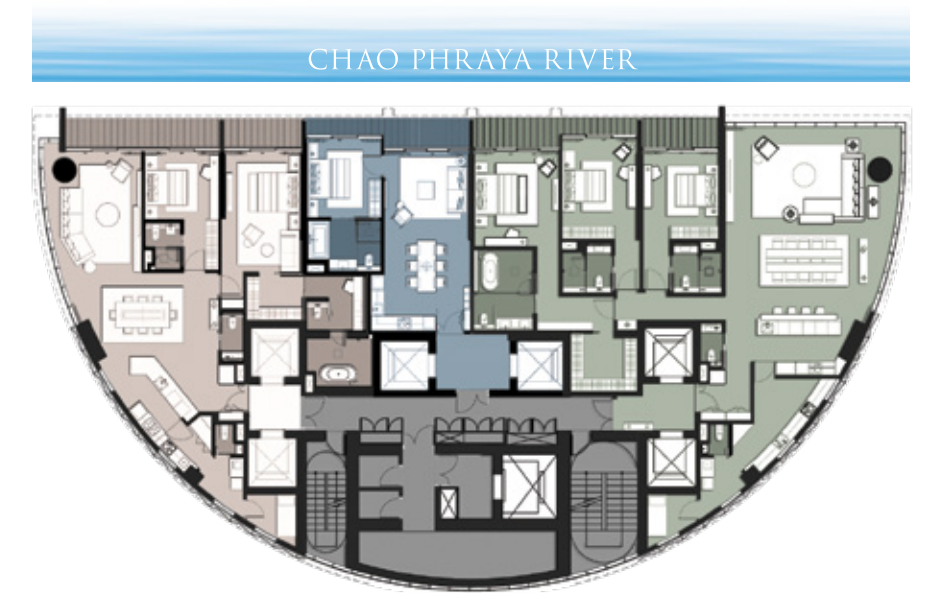
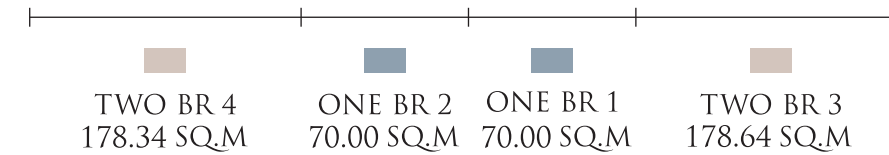

FLOORS 26 - 41



FLOOR PLAN

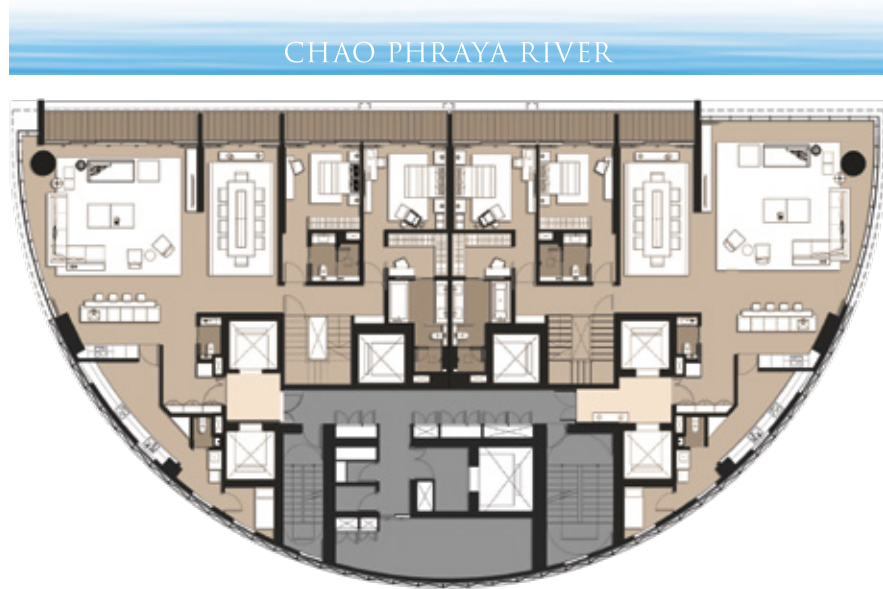

LOWER FLOOR
FLOOR 42

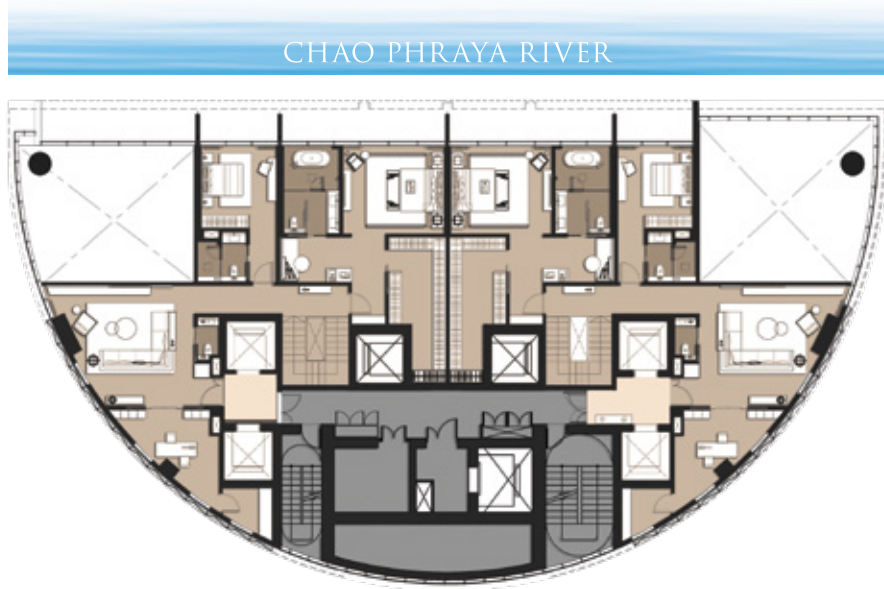
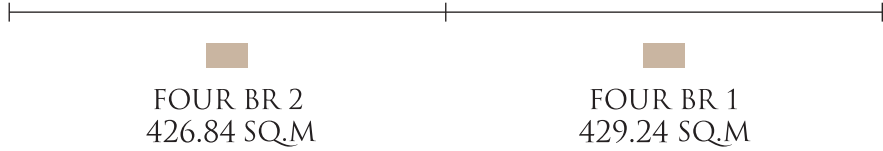

UPPER FLOOR
FLOOR 43

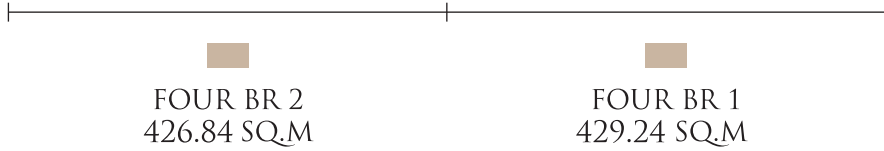

FLOOR PLAN



LOWER FLOOR
FLOOR 44

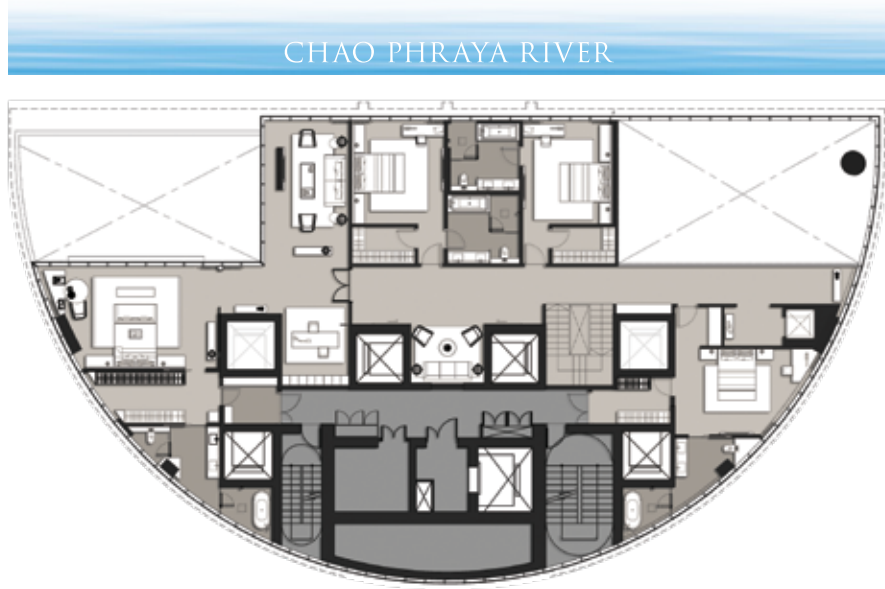
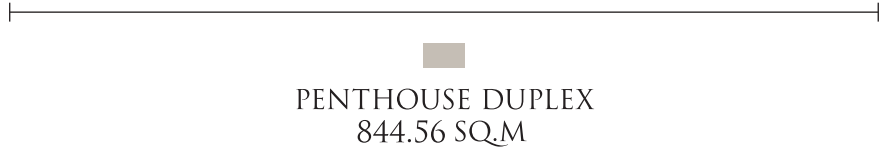

UPPER FLOOR
FLOOR 45



ONE BEDROOM 1
(70.00 SQ.M)

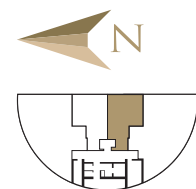

ONE BEDROOM 2
(70.00 SQ.M)

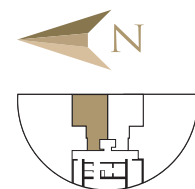

ONE BEDROOM 3
(78.56 SQ.M)

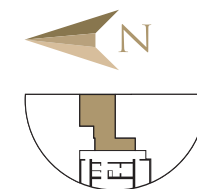

ONE BEDROOM 4
(87.09 SQ.M)

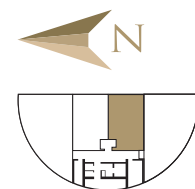
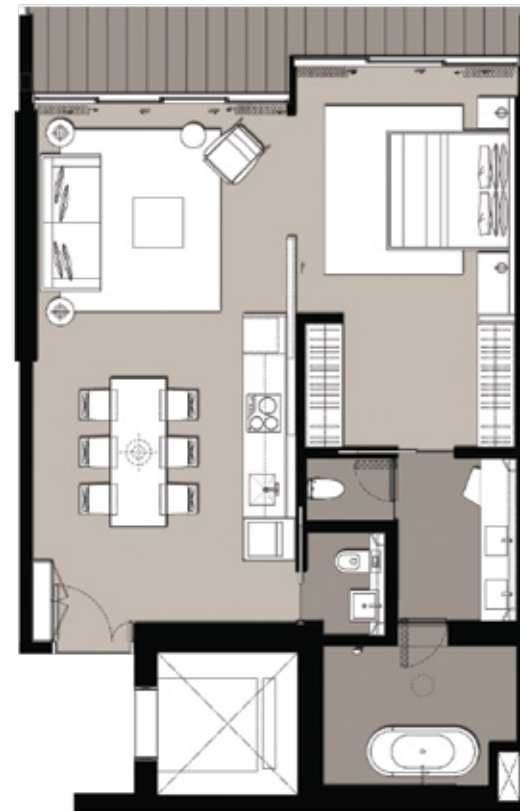

ONE BEDROOM 5
(87.01 SQ.M)

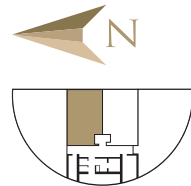

TWO BEDROOM 1
(160.85 SQ.M)

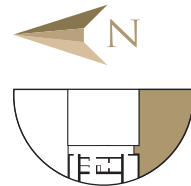

TWO BEDROOM 2
(160.45 - 160.61 SQ.M)

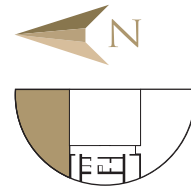

TWO BEDROOM 3
(178.64 SQ.M)

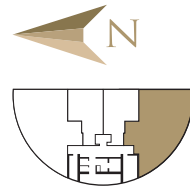

TWO BEDROOM 4

(178.34 SQ.M)

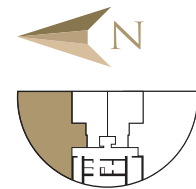

TWO BEDROOM 5

(181.23 SQ.M)

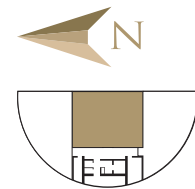

THREE BEDROOM

(248.29 SQ.M)

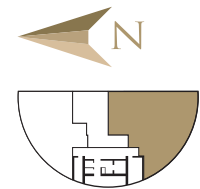

FOUR BEDROOM DUPLEX 1

(426.82 SQ.M)



LOWER FLOOR
FLOOR 42



UPPER FLOOR
FLOOR 43

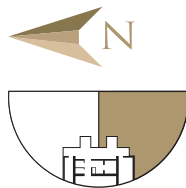

FOUR BEDROOM DUPLEX 2

(429.24 SQ.M)



LOWER FLOOR
FLOOR 42



UPPER FLOOR
FLOOR 43

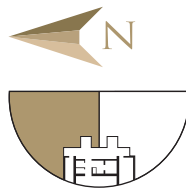

PENTHOUSE DUPLEX

(844.56 SQ.M)

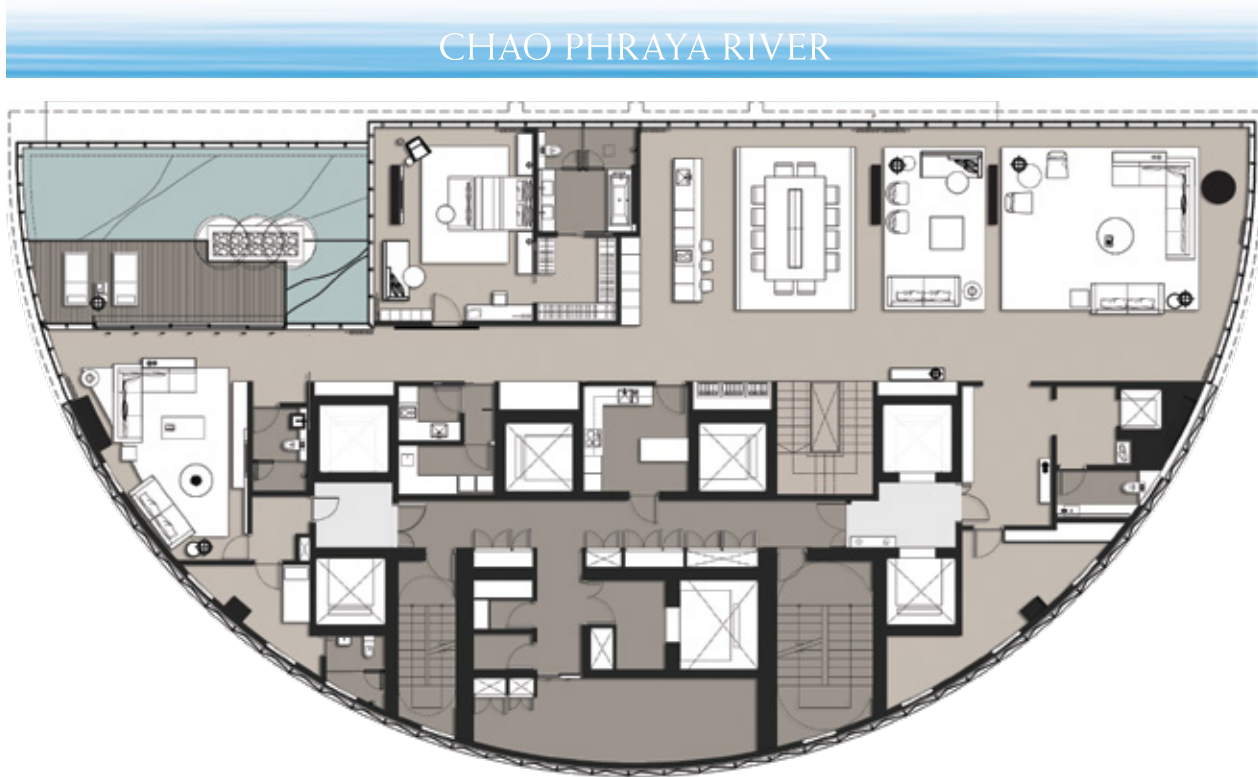

LOWER FLOOR
FLOOR 44

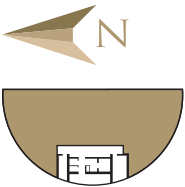

PENTHOUSE DUPLEX

(844.56 SQ.M)

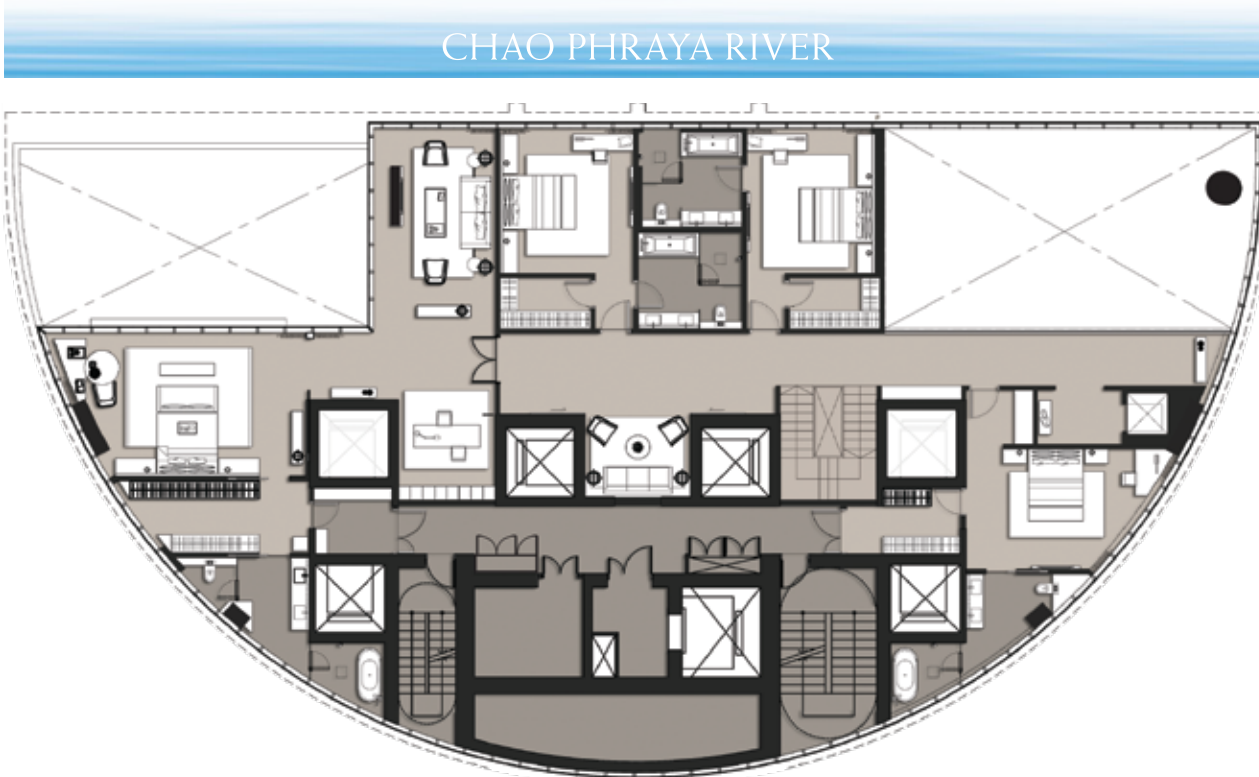

UPPER FLOOR
FLOOR 45

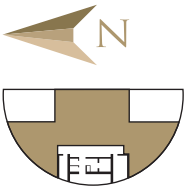



BANYAN TREE
RESIDENCES
— RIVERSIDE BANGKOK —





BANYAN TREE
RESIDENCES
— RIVERSIDE BANGKOK —

1188 Banyan Tree Residences Riverside Bangkok, Soi Somdet Chao Phraya 17, Khwaeng Khlong San, Khet Khlong San, Bangkok 10600

WWW.BANYANTREERESIDENCESRIVERSIDEBANGKOK.COM

DISCLAIMER : THIS PLAN IS ILLUSTRATIVE. THE FINAL SURVEY PLAN TAKES PRECEDENCE IN RESPECT OF ALL AREAS, MEASUREMENTS AND CONFIGURATION OF THE APARTMENT. THIS PLAN DOES NOT FIX THE LOCATION OF BUILDINGS, OR OTHER IMPROVEMENTS, EXCLUSIVE USE AREAS OR COMMON PROPERTY OR THE INTERNAL OR EXTERNAL BOUNDARIES ON ANY OF THEM. DESIGNS, FEATURES, COLOURS AND MATERIALS MAY VARY FROM THOSE SHOWN ON COMPLETION OF COMPLETION OF CONSTRUCTION. NO PERSON SHOULD RELY ON THIS PLAN AS DETERMINING THE FINAL DESIGN, APPEARANCE, CONTENT OR AS CONSTRUCTED FORMAT OF THE BUILDINGS OR OTHER IMPROVEMENTS AND FEATURES SHOWN. TO THE EXTENT PERMITTED BY LAW, LIABILITY FOR LOSS OR DAMAGE INCURRED OR SUFFERED BY ANY PERSON WHO ACTS OR MAKES DECISIONS ON THE BASIS OF THIS PLAN IS EXCLUDED. BANYAN TREE IS NOT THE DEVELOPER AND IS NOT AFFILIATED WITH NVD.

1787  NVD
Nirvana Dail PLC.